

STANDARD OPTIONS:

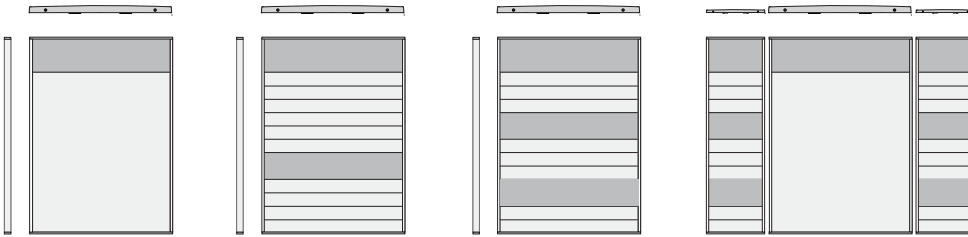

ASSEMBLY:

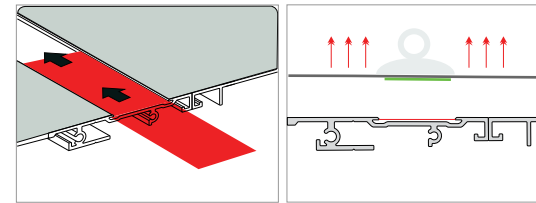

b	Aluminum Panel Anodized / Natural						
mm	20	25	30	40	50	60	100
inch	0.79	1	1.18	1.57	1.97	2.36	3.94

b=Individual panel height. Thickness 2 mm/0.079inch

Standard sizes	No.	Part No.	A		AA		AAA	
			H x W		H x W		H x W	
			mm	inch	mm	inch	mm	inch
	1	Mir2124P	178 x 222	7 x 8.74	222 x 222	8.74 x 8.74	305 x 222	12 x 8.74
	2	Mir2161P	254 x 304	10 x 11	304 x 304	11 x 11	405 x 304	16 x 11
	3	Mir2162P	305 x 404	12 x 15.9	404 x 404	15.9 x 15.9	605 x 404	24 x 15.9
	4	Mir2299P	305 x 436	12 x 17	436 x 436	17 x 17	605 x 436	24 x 17
	5	Mir2163P	436 x 504	17 x 19.8	504 x 504	19.8 x 19.8	813 x 504	32 x 19.8
	6	Mir2164P	508 x 604	20 x 23.7	604 x 604	23.7 x 23.7	1020 x 604	40 x 23.7

**d**  
ACCENT BAR  
(available page no.\*)  
Finish/color Options:  
1. Standard Mirtec anodized colors  
2. can be painted or powder coated



4.1

Venus Sign Family  
Directory with Aluminum Panels

NOTES:

- a**  
EXTRUSION finish/color options:  
are made from high quality aluminum 6063 with an anodized or oven cured coating  
1. Clear anodized aluminum
- b**  
INSERT OPTIONS:  
1. Graphic sign fronts:  
engraved, laminated, silk screened, Imprinted with braille or photo metal finished  
2. Applied vinyl on aluminum insert  
3. 1. .040 aluminum backed photopolymer w/ raised symbols/copy and ADA compliant braille. Tip symbols/copy to contrast background braille to remain background color  
4. Acrylic cover w/ paper insert  
5. Digital printing onto anodized aluminum by Primodize® or direct on clear cover

PANELS

1. Natural or anodized alum strips

**c**

- END CAPS finish/color options:  
1. Clear anodized aluminum  
2. Can be painted or powder coated  
3. Gray or black ABS plastic  
4. Clear anodized aluminum base

